

# LC2T

CATEGORY	FOODSERVICE UPRIGHTS
RANGE	<b>Crystal Bakery</b>
UNIT	FREEZER
TYPE	SELF CONTAINED
DOORS	2

WA DEALER  
PRACTICAL PRODUCTS PTY LTD

PH: 08 9302 1299  
51 Paramount Dr Wangara WA 6065  
sales@practicalproducts.com.au  
www.practicalproducts.com.au

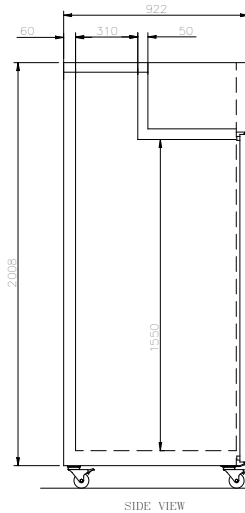

SIDE VIEW

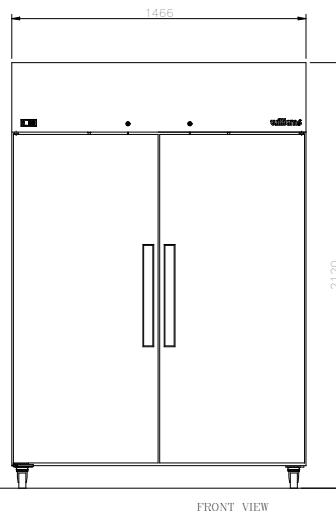

FRONT VIEW

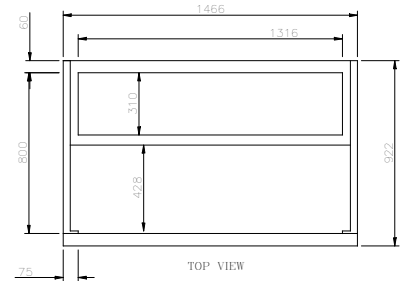

TOP VIEW

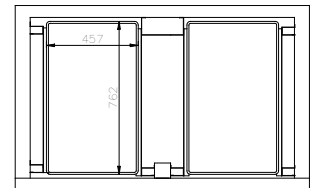

TOP INTERNAL VIEW

## SPECIFICATIONS

CAPACITY LITRES	1630
TEMPERATURE - 43°C AMBIENT ENVIRONMENT	-13°C / -21°C
DIMENSIONS - W X D X H (ON CASTORS) MM	1466 W x 922 D x 2120 H
WEIGHT UNPACKED (KG)	230

## STANDARD INCLUSIONS \*\*\*

DOOR TYPE	Standard: S (Solid Door)
FINISH (INTERIOR & EXTERIOR EXCLUDING REAR & UNDER)	S (Stainless Steel) CB (White)
TRAY SLIDES PER DOOR (NO TRAYS OR SHELVES SUPPLIED)(ACCOMODATES 18" OR 16" TRAYS)	20

## ELECTRICAL

POWER SUPPLY	10 amp
POWER CABLE LENGTH (METRES)	2
RUNNING AMPS	5.4

## GAS TYPE

REFRIGERANT	R404a
-------------	-------

## REFRIGERATION WATTAGES FOR OPTIONAL REMOTE UNITS

FREEZER MODELS - SOLID DOORS	1020 @ -30°C SST
------------------------------	------------------