

STGBM9 TOWER COUNTER SERIES BAIN MARIE



COSSIGA

STGBM9-SD



PRODUCT FEATURES

- Wet or dry elements
- Overhead heat lamps
- Single glazed
- Sliding rear doors
- Solid front or sliding front doors
- Manual water fill

STGBM9



WA DEALER
PRACTICAL PRODUCTS PTY LTD
PH: 08 9302 1299
51 Paramount Dr Wangara WA 6065
sales@practicalproducts.com.au
www.practicalproducts.com.au

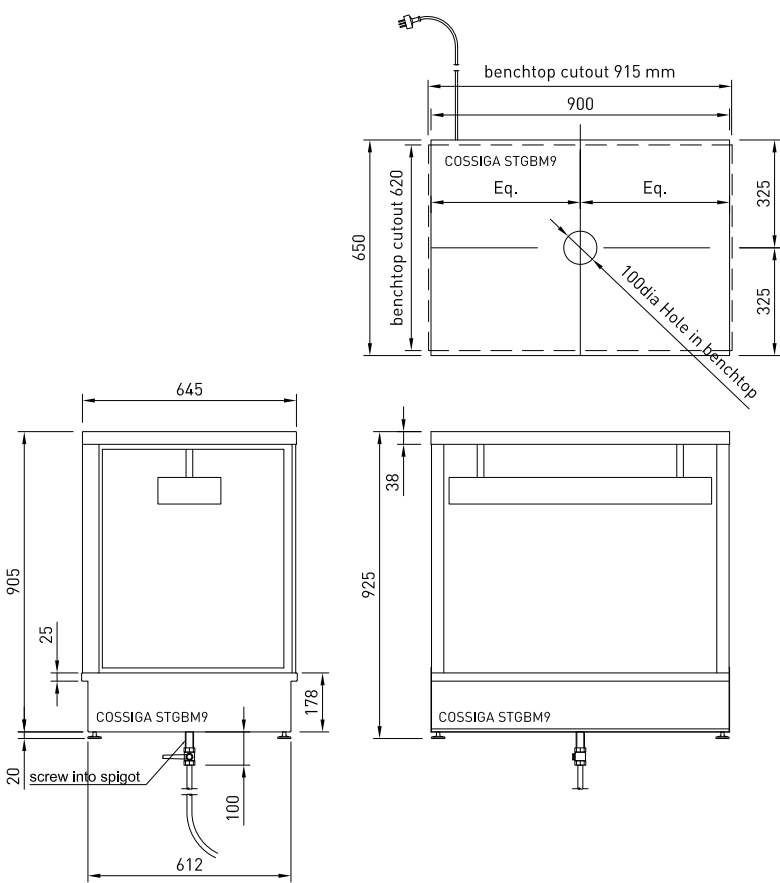

CABINET DIMENSIONS & SPECIFICATIONS

Prior to installation see, installation guidelines, ventilation requirements and drainage options documents

MODEL	CABINET				CUT OUTS	SHELVING		BASE TRAY	DISPLAY M ²	INTERNAL VOLUME M ³	POWER		CONNECTION ELECTRICAL POWER CORD 2200MM		VOLTAGE	PACKED FOR SHIPPING			
	LENGTH [MM]	DEPTH [MM]	HEIGHT [MM]	WEIGHT [KG]		NO.	SIZE W X D	SIZE W X D			KW 230V	AMPS	NZ/AUS	UK		LENGTH [MM]	DEPTH [MM]	HEIGHT [MM]	WEIGHT [KG]
STGBM9-SD STGBM9	900	650	925	99	915x620	n/a	n/a	n/a	0.54	0.31	2.28	9.9	LEAD ONLY	LEAD ONLY	220~240V	700	730	1100	104



STGBM12 TOWER COUNTER SERIES BAIN MARIE



COSSIGA

STGBM12-SD



PRODUCT FEATURES

- Wet or dry elements
- Overhead heat lamps
- Single glazed
- Sliding rear doors
- Solid front or sliding front doors
- Manual water fill

STGBM12

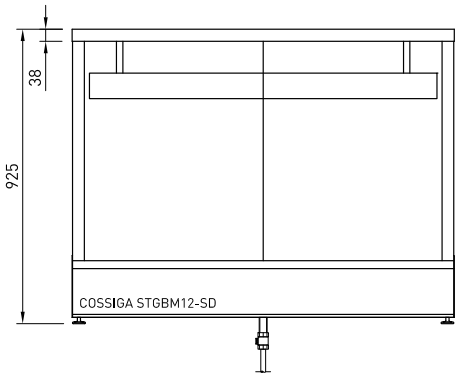
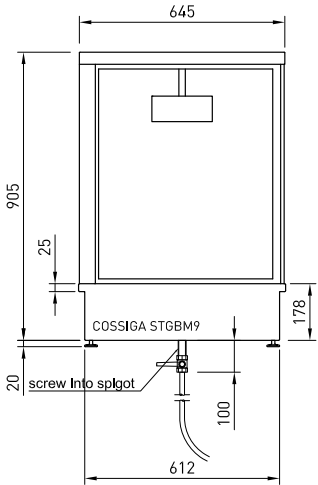
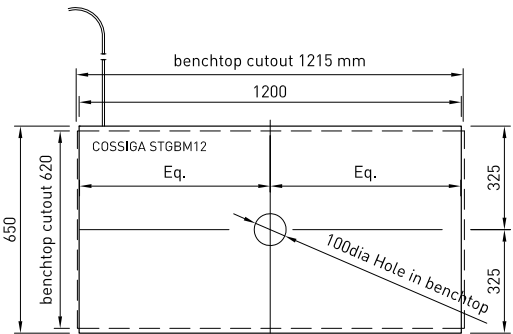

WA DEALER
PRACTICAL PRODUCTS PTY LTD
PH: 08 9302 1299
51 Paramount Dr Wangara WA 6065
sales@practicalproducts.com.au
www.practicalproducts.com.au

CABINET DIMENSIONS & SPECIFICATIONS

Prior to installation see, installation guidelines, ventilation requirements and drainage options documents

MODEL	CABINET				CUT OUTS	SHELVING		BASE TRAY	DISPLAY M ²	INTERNAL VOLUME M ³	POWER		CONNECTION ELECTRICAL POWER CORD 2200MM		VOLTAGE	PACKED FOR SHIPPING			
	LENGTH [MM]	DEPTH [MM]	HEIGHT [MM]	WEIGHT [KG]		NO.	SIZE W X D	SIZE W X D			KW 230V	AMPS	NZ/AUS	UK		LENGTH [MM]	DEPTH [MM]	HEIGHT [MM]	WEIGHT [KG]
STGBM12-SD STGBM12	1200	650	925	119	1215x620	n/a	n/a	n/a	0.72	0.34	2.53	11	LEAD ONLY	LEAD ONLY	220~240V	1000	730	1100	124



STGBM15 TOWER COUNTER SERIES BAIN MARIE



COSSIGA

STGBM15-SD



PRODUCT FEATURES

- Wet or dry elements
- Overhead heat lamps
- Single glazed
- Sliding rear doors
- Solid front or sliding front doors
- Manual water fill

STGBM15

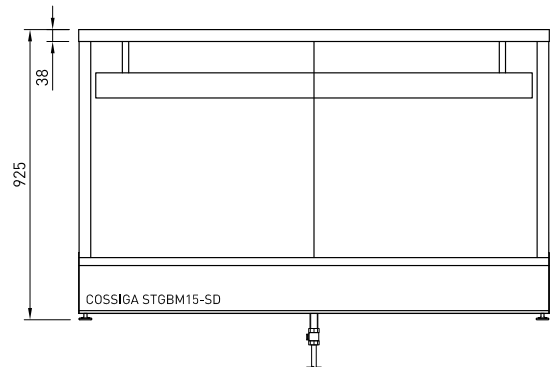
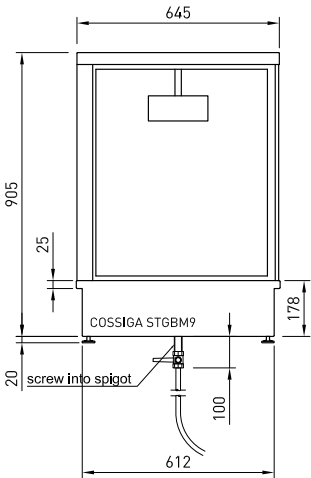
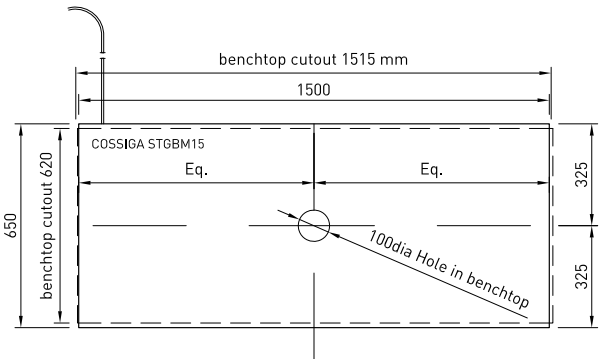

WA DEALER
PRACTICAL PRODUCTS PTY LTD
PH: 08 9302 1299
51 Paramount Dr Wangara WA 6065
sales@practicalproducts.com.au
www.practicalproducts.com.au

CABINET DIMENSIONS & SPECIFICATIONS

Prior to installation see, installation guidelines, ventilation requirements and drainage options documents

MODEL	CABINET				CUT OUTS	SHELVING		BASE TRAY	DISPLAY M ²	INTERNAL VOLUME M ³	POWER		CONNECTION ELECTRICAL POWER CORD 2200MM		VOLTAGE	PACKED FOR SHIPPING			
	LENGTH [MM]	DEPTH [MM]	HEIGHT [MM]	WEIGHT [KG]		NO.	SIZE W X D	SIZE W X D			KW 230V	AMPS	NZ/AUS	UK		LENGTH [MM]	DEPTH [MM]	HEIGHT [MM]	WEIGHT [KG]
STGBM15-SD STGBM15	1500	650	925	140	1515x620	n/a	1n/a	n/a	0.9	0.46	3.48	15	LEAD ONLY	LEAD ONLY	220~240V	1300	730	1100	145

