

Waldorf Bold

Bench Top 600mm

BTLB8600-CD, BTLB8600-LS



BTLB8600-CD

OVERALL CONSTRUCTION

WORK BENCH

- 3.5mm thick compound work surface
 - 1.5mm 304 stainless steel top
 - 2.0mm galvanised steel backing
- Welded 1.5mm stainless steel bull nose
- Splashback and side panels 1.2mm stainless steel

CABINET BASE (SUPPLIED AS -CD MODEL)

- Modular for suite matched finish
- Double skin 0.9mm stainless steel interior and exterior
- GN 1/1 4 position racking kit
- 63mm dia. heavy-duty 1.2mm stainless steel legs with adjustable feet

LEG STAND (SUPPLIED AS -LS MODEL)

- Modular for suite matched finish
- 63mm dia. heavy-duty 1.2mm stainless steel legs with adjustable feet
- Framed stand shelf with 0.9mm stainless steel finish
- Quick assembly design (no tools required)

- Heavy-duty construction
- Cabinet Base or Leg Stand
- Stainless steel exterior
- Black vitreous enamel finish to front panels
- Easy clean
- Fully modular

Series Options

- BTLB - Low back models
- BTB - 215mm splashback option

Bench Top 600mm

BTLB8600-CD

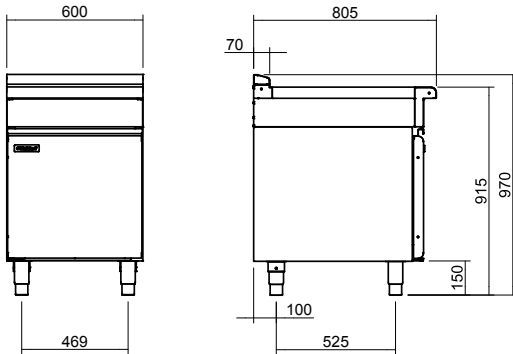

BTLB8600-LS

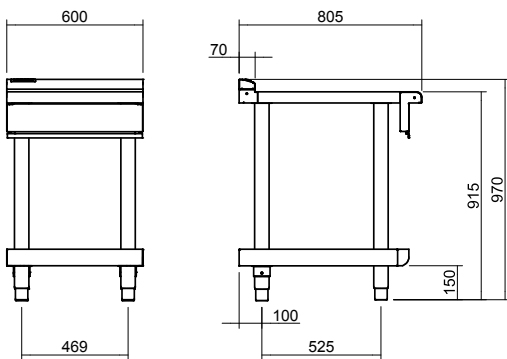

BTLB8600

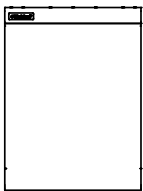

SPECIFICATIONS

Dimensions

Width 600mm
 Depth 805mm
 Height 915mm
 Incl. low back 970mm
 Incl. splashback option 1130mm

Nett weight

Cabinet Base models 59kg
 Leg Stand models 47kg

Packing data

Cabinet Base models
 0.55m³, 111kg
 Width 495mm
 Depth 870mm
 Height 1260mm
 Leg Stand models
 0.29m³, 83kg
 Width 495mm
 Depth 870mm
 Height 665mm

OPTIONS AT EXTRA COST

Castors
 Plinth mounting



WA DEALER
PRACTICAL PRODUCTS PTY LTD

PH: 08 9302 1299
 51 Paramount Dr Wangara WA 6065
 sales@practicalproducts.com.au
 www.practicalproducts.com.au